

**ADJUST. 2 HOLES FLANGE PLUG RECEPTACLE  
WITH CYLINDRICAL CONTACT**

**R114.450.205**  
**SERIES SMB**

4 Creves pour immobilisation du contact-central  
(4 idents for center-contact captivation).  
(4-Punkt-Crimpung zur Fixierung des innenleiters).

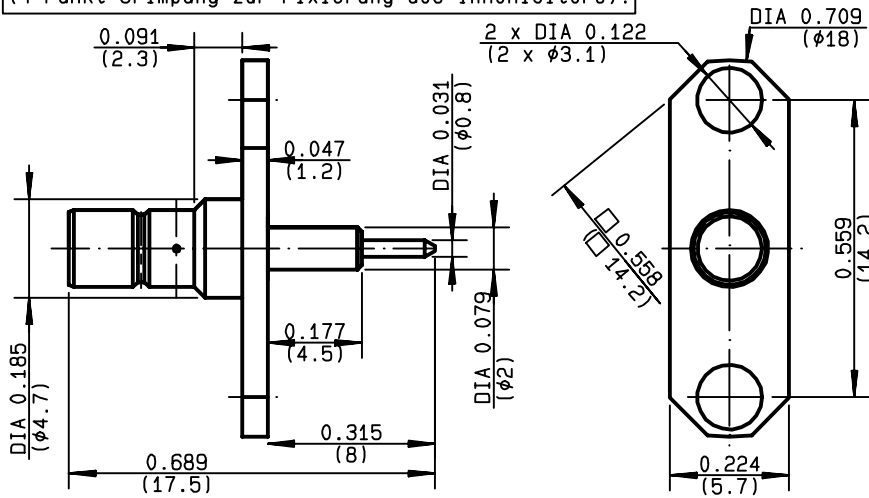

MOUNTING HOLE  
PERCAGE PANNEAU  
BOHRPLAN

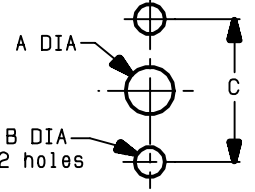

	MM		INCH	
	maxi	mini	maxi	mini
A	2.30	2.15	0.091	0.085
B	3.20	3.05	0.126	0.120
C	14.4	14.0	0.565	0.552

NOMINAL IMPEDANCE	<b>50</b>	$\Omega$
FREQUENCY RANGE	<b>0-4</b>	GHz
TEMPERATURE RATING	<b>-65/+155</b>	$^{\circ}C$
V.S.W.R	<b>1.15</b> +	x F(GHz)Maxi
RF INSERTION LOSS	<b>0.03*</b>	$\sqrt{F}$ (GHz) dB Maxi
VOLTAGE RATING	<b>335</b>	Veff Maxi
DIELECTRIC WITHSTANDING VOLTAGE	<b>1000</b>	Veff Mini
INSULATION RESISTANCE	<b>1000</b>	M $\Omega$ Mini
HERMETIC SEAL	<b>NA</b>	Atm.cm <sup>3</sup> /s
LEAKAGE (pressurized only)	<b>NA</b>	
MECHANICAL DURABILITY	<b>500</b>	Cycles
WEIGHT	<b>1.31</b>	gr
SPECIFICATION		

CABLES :

OTHERS CHARACTERISTICS

**\* COAXIAL TRANSMISSION LINE ONLY**

CABLE RETENTION	<b>NA</b>	N Mini
CENTER CONTACT RETENTION		
Axial force - mating end	<b>10</b>	N Mini
Axial force - opposite end	<b>10</b>	N Mini
Torque	<b>NA</b>	cm.N Mini
RECOMMENDED TORQUES		
Mating	<b>NA</b>	cm.N
Panel nut	<b>NA</b>	cm.N
Clamp nut	<b>NA</b>	cm.N

CONNECTOR PARTS:	MATERIALS	FINISH	(all values are given in micrometers)
BODY	BRASS	NICKEL 2	
OUTER CONTACT			
CENTER CONTACT	BRASS	GOLD 1.3 OVER NICKEL 2	
INSULATOR	PTFE	-	
GASKET		-	
OTHERS PIECES			

ISSUE	CREATION DATE	FILE PART-NUMBER
<b>9943B00</b>	<b>28/02/1997</b>	<b>96-0104-425</b>



ILLMER

The information given here is subject to change without notice.  
Design changes may be in order to improve the product .

*Connect to the future*